



Pro-Fill Load Alert w/Auto-Fill

910-173, 12, 15, 17, 20 lb (7" dia)

910-174, 25 – 85 lb (10" dia)

910-175, 135 – 200 lb

Description

HMT's Pro-Fill Load Alert is a weight sensing device designed to notify the operator when the melt tank needs to be re-filled. When the Load Alert is used with the Automatic Fill option, the adhesive is vacuumed into the tank automatically without operator assistance.

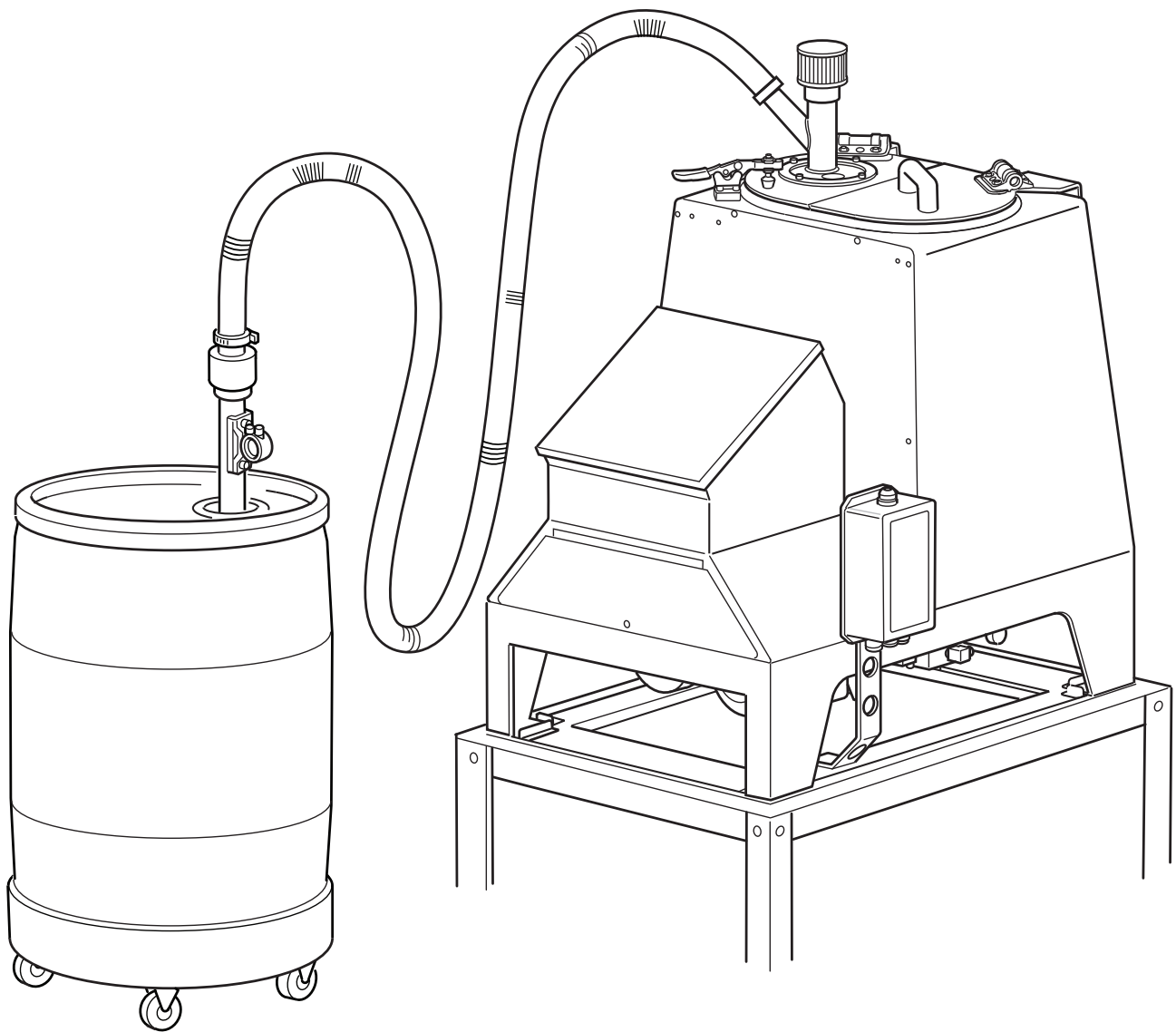



Pro-Fill Load Alert w/Auto-Fill

Setup

Place the Load Alert on HMT's standard cart or a level surface that can safely accommodate the overall weight.

Make sure that the mounting surface is free of debris.

The Load Alert Scale Platform must have clearance on all four (4) sides. If the sides of the Scale Platform contact the melt unit cart or other objects, the Load Alert may not function correctly.

Place the melt unit on the Load Alert as shown in the diagram.

The melt unit must rest within the eight (8) tabs on top of the Load Alert Scale Platform.

Supply power to the Load Alert.
120–240 VAC (.25 A)

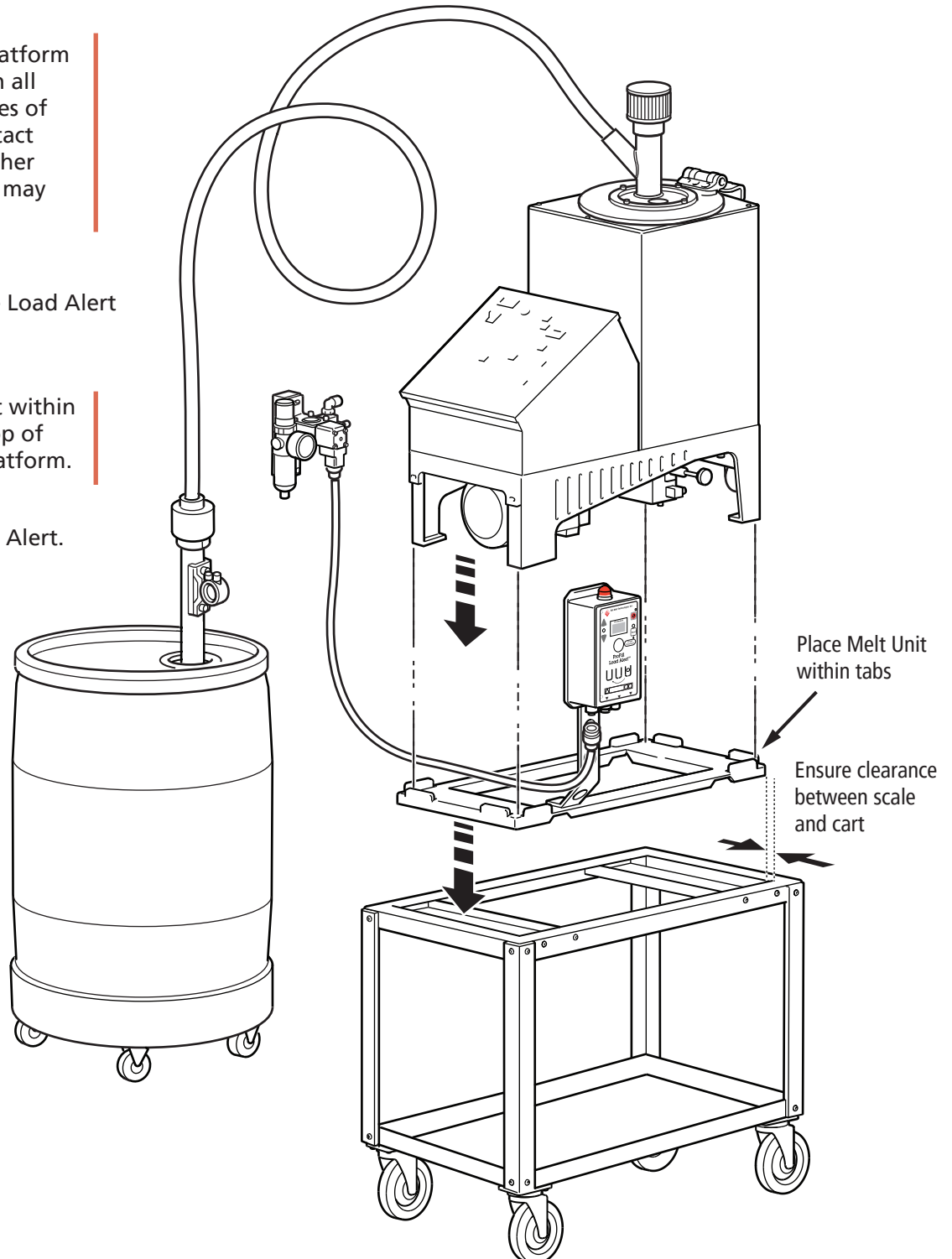

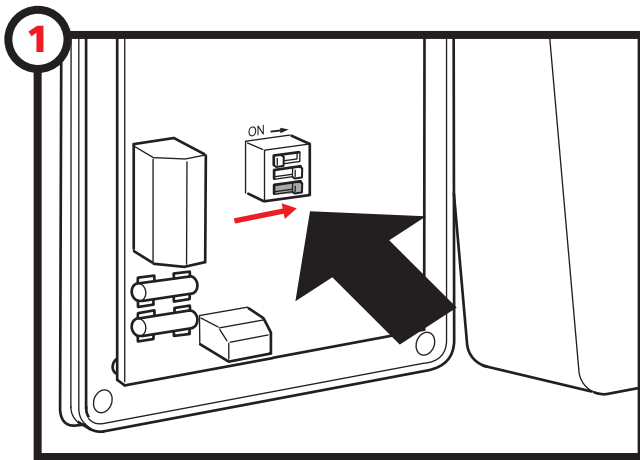

To enable Auto-Fill, move the third switch to the "ON" position

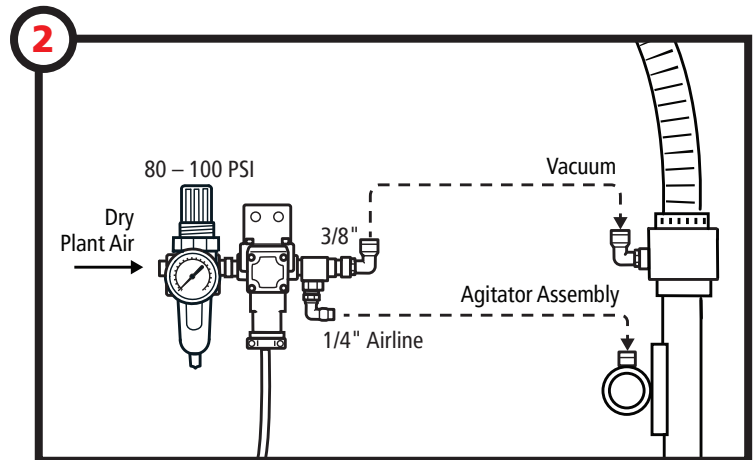

Set up Auto-Fill Air Control Assembly as illustrated.

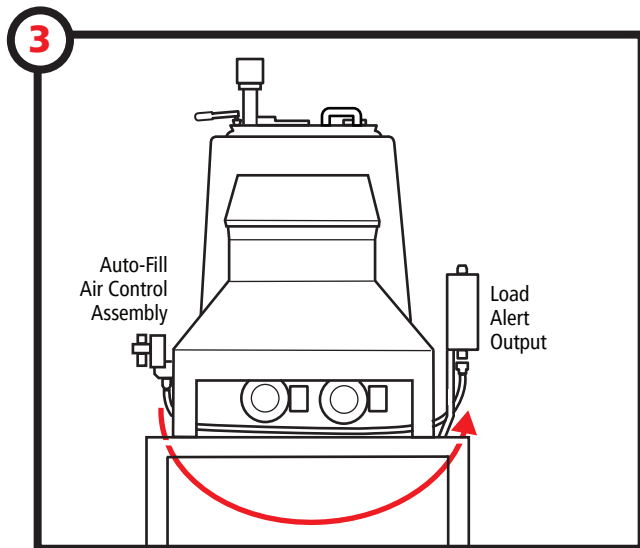

Connect the Auto-Fill to the Load Alert.

WARNING! Disconnect power to the control box before opening!

Troubleshooting

Underfill

- ▶ Underfill can occur if additional weight is placed on the Load Alert scale platform during normal operation.

Overfill

- ▶ Overfill can occur if additional weight is on the Load Alert scale platform when it is setup, but removed afterwards.

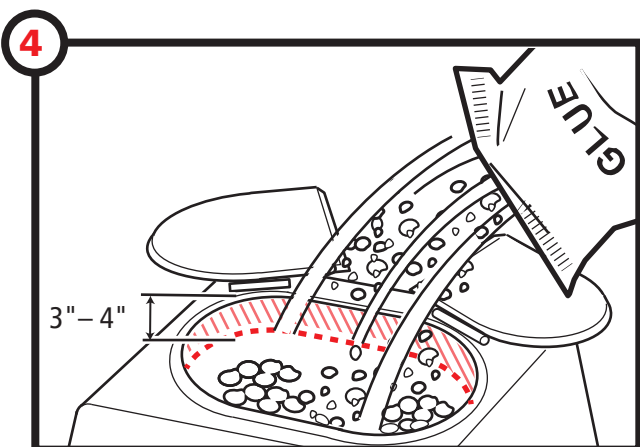

The tank should be filled allowing a 3" - 4" air gap under the lid.



IMPORTANT REMINDER

Remember, Load Alert is a weight sensing system. During use, DO NOT add or remove items from the system that might affect the over-all system weight. For example, handguns should not be mounted to the machine. Lifting and replacing the handgun will affect the Load Alert weight calibration and response accuracy.



Pro-Fill Load Alert w/Auto-Fill

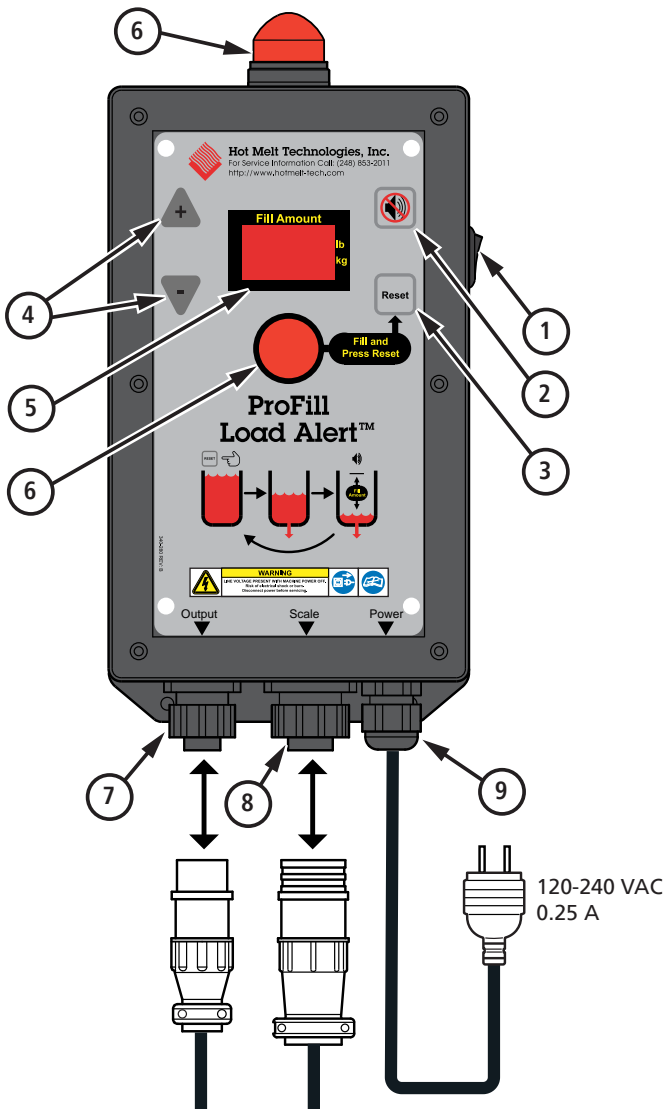

- 1 Power Switch
- 2 Quiet Button
Silences audible alarm
- 3 Reset Button
Resets the Load Alert
- 4 Up/Down Buttons
Increase or decrease "Fill Amount"
- 5 Fill Amount Display
- 6 LED indicator
Flashes and alarms when the tank re-fills
- 7 Auto-Fill Connector
- 8 Scale Platform Connector
- 9 Power Input



IMPORTANT REMINDER

Remember, Load Alert is a weight sensing system. During use, DO NOT add or remove items from the system that might affect the over-all system weight. For example, handguns should not be mounted to the machine. Lifting and replacing the handgun will affect the Load Alert weight calibration and response accuracy.

Set-up Instructions:

1. Load the tank with adhesive
 - **Important:** leave at least 3"– 4" of air space under lid
2. Select the "Fill Amount" (see chart)
3. Press and Hold "Reset" until the LED light flashes (approximately 5 seconds)
4. Operate normally

Normal Operation

1. Operate normally
2. Visual and Audible alarms when the tank needs a "Re-fill"
3. The Auto-Fill vacuum re-fills the tank
4. Repeat Process

Benchmark or ProFlex Tank Size (lb)	Recommended Fill Amount
15 – 35	1 lb
50 – 85	2 lb
135 – 200	5 lb

SPECIAL NOTE

Depending on the melt rate and usage rate of your adhesive, you may periodically wish to adjust the "full" level in the melt tank. But always remember—always leave at least 3"– 4" of air space under lid.



Pro-Fill Load Alert w/Auto-Fill

