

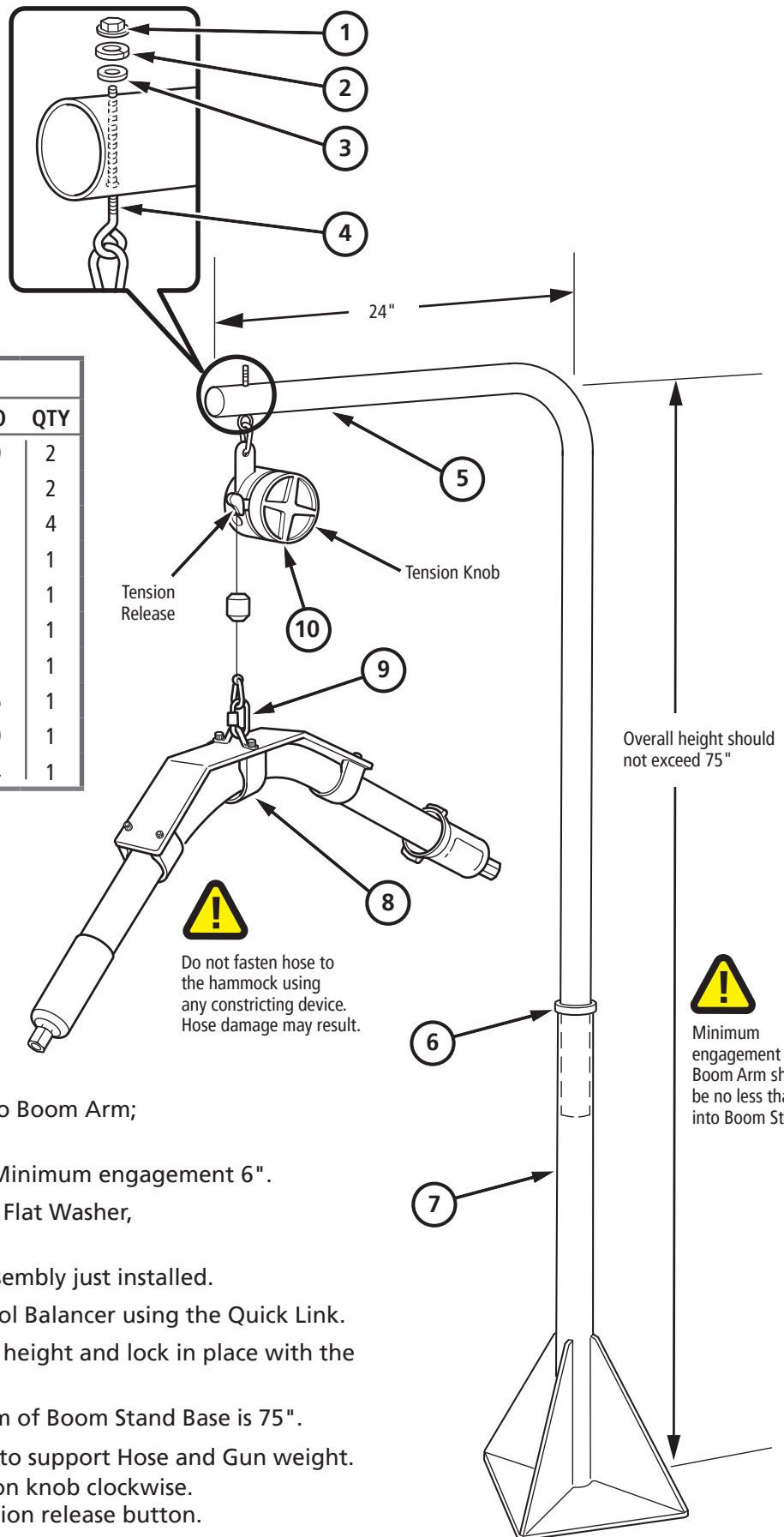

# Boom & Balancer

933-001

BILL OF MATERIALS			
ITEM	DESCRIPTION	PART NO	QTY
1	Hex Nut 1/4-20	310-019	2
2	Lock Washer 1/4"	316-007	2
3	Flat Washer 1/4"	315-007	4
4	Eye Bolt 1/4-20 X 1"	300-015	1
5	Boom Arm	170-002	1
6	Height Adjustment Collar	300-013	1
7	Boom Stand	170-001	1
8	Hose Hammock	933-006	1
9	Quick Link	300-009	1
10	Tool Balancer	170-004	1



- Secure Boom Stand to work area.
- Install Height Adjustment Collar onto Boom Arm; leave it loose at this time.
- Insert Boom Arm into Boom Stand. Minimum engagement 6".
- Insert Eye Bolt into Boom Arm using Flat Washer, Lock Washer and Hex Nut as shown.
- Clip Tool Balancer to the Eye Bolt assembly just installed.
- Attach the Hose Hammock to the Tool Balancer using the Quick Link.
- Adjust the Boom Arm to the desired height and lock in place with the Height Adjustment Collar.  
NOTE: Maximum height from bottom of Boom Stand Base is 75".
- Adjust Tension on the Tool Balancer to support Hose and Gun weight.
  - To increase tension turn the tension knob clockwise.
  - To decrease tension press the tension release button.

